

# Beer Filtration

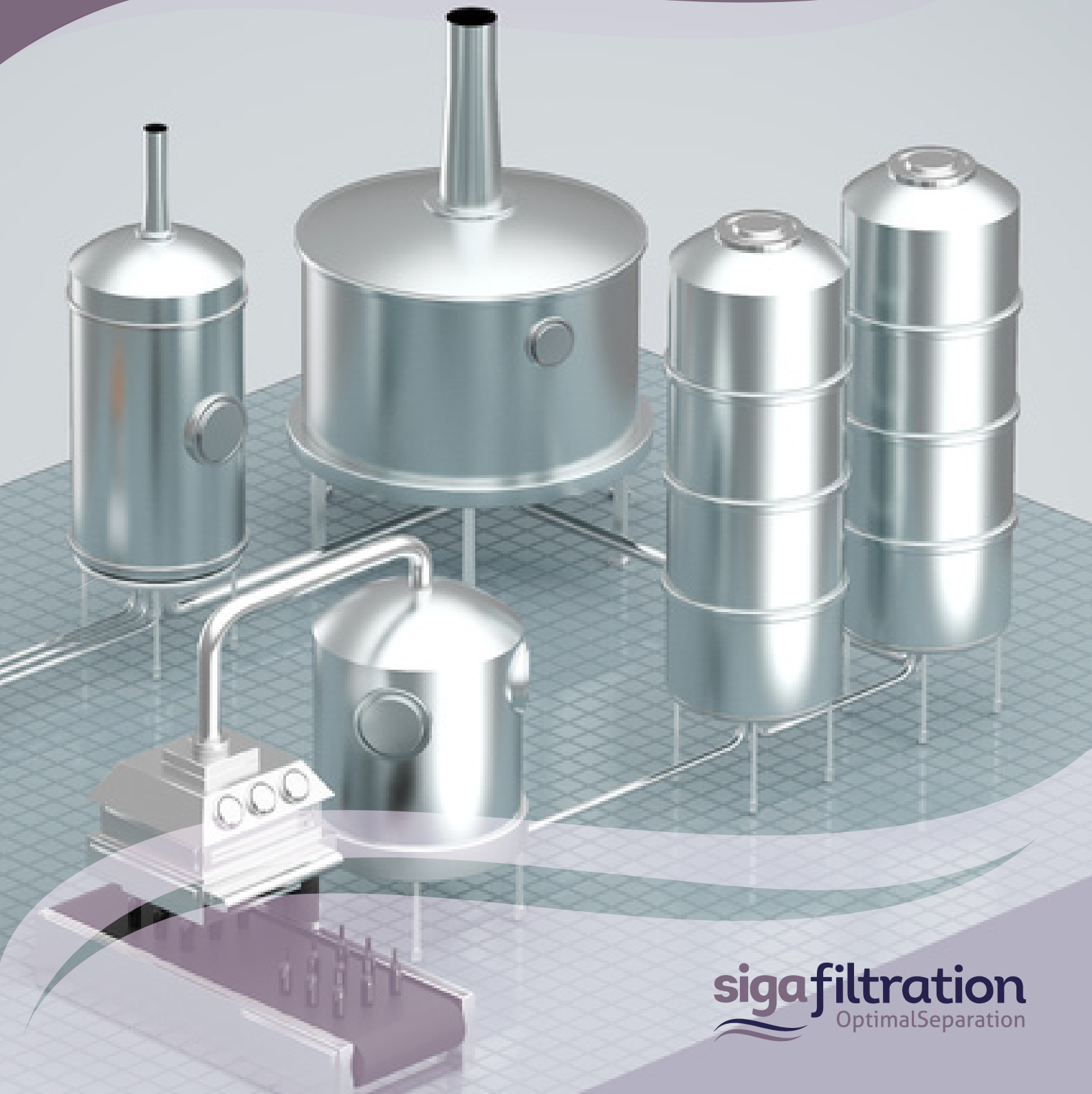

# BEER FILTRATION

Siga Filtration offers filtration systems for small and large breweries for particulate, yeast and bacteria removal.

These systems are used end of line, prior to bottling/kegging to give a bright beer finish and to improve shelf life.

Filter cartridge selection remains unchanged for small and large breweries.

If sterile filtration is not required, then we can offer the first two stages to remove suspended solids and yeast.

## THREE STAGE FILTRATION SYSTEMS

### Stage 1 – Clarification

To remove visible and suspended particulates from beer.

### Stage 2 – Fine Particulate & yeast removal. Protection of Stage 3 filter.

Remove fine particulates, yeast and other compounds that might cause beer haze after chilling. Protect sterile membrane used in stage 3 and increase service life.

### Stage 3 – Sterile filtration

Remove beer spoilage organisms to increase shelf life.

## OUR FILTERS



BREW/Fil ECO

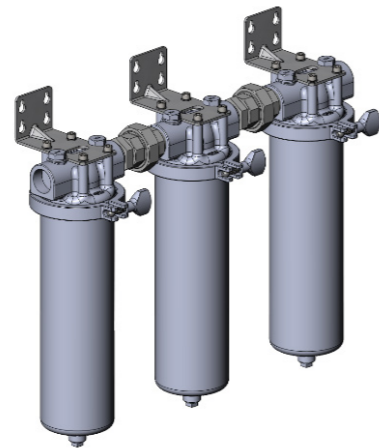

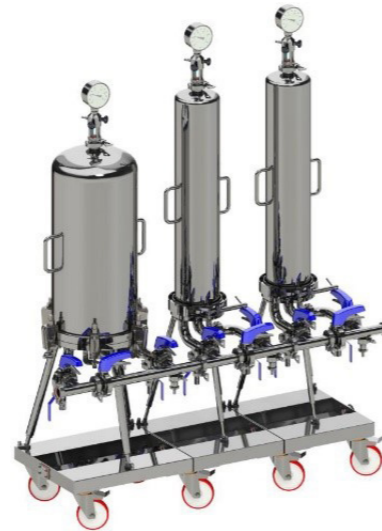

BREW/Fil Standard



BREW/Fil Sanitary  
(With or without skid)

## Specifications

	 BREW/Fil ECO	 BREW/Fil Standard	 BREW/Fil Sanitary (With or without skid)
<b>Features &amp; Application</b>	<ul style="list-style-type: none"> <li>• Food grade materials</li> <li>• Pre-production or trial stage</li> <li>• Microbreweries</li> <li>• Cost effective</li> <li>• Polypropylene construction</li> </ul>	<ul style="list-style-type: none"> <li>• Food grade materials</li> <li>• Microbreweries</li> <li>• 304 or 316 Stainless Steel construction</li> </ul>	<ul style="list-style-type: none"> <li>• Food grade materials</li> <li>• Micro and large breweries</li> <li>• 316L Stainless Steel</li> <li>• Full sanitary construction</li> <li>• Surface roughness &lt;0.6Ra</li> <li>• Mechanically polished</li> <li>• Optional material certificates</li> </ul>
<b>Flow rate Capability</b>	up to 600 L/h (1 m <sup>3</sup> /h)	up to 2000 L/h (2 m <sup>3</sup> /h)	500 – 30,000 L/h (0.5 – 30 m <sup>3</sup> /h) Larger systems available
<b>What is included</b>	<ul style="list-style-type: none"> <li>• 3 x plastic cartridge filter housings fully assembled in series mounted on central bracket</li> <li>• 1 x spanner</li> <li>• 1 x mounting bracket</li> <li>• 2 x inlet/outlet pressure gauges</li> <li>• 5 x Stage 1 filter cartridges</li> <li>• 3 x Stage 2 filter cartridges</li> <li>• 3 x Stage 3 filter cartridges</li> </ul>	<ul style="list-style-type: none"> <li>• 3 x 1FUC Stainless steel filter housings fully assembled in series</li> <li>• 3 x mounting brackets</li> <li>• Optional trolley or stand</li> <li>• Optional differential pressure gauge to indicate blocked filters</li> <li>• Optional adaptors, BSP to triclamp or BSP to DIN11851</li> <li>• 5 x Stage 1 filter cartridges</li> <li>• 3 x Stage 2 filter cartridges</li> <li>• 3 x Stage 3 filter cartridges</li> </ul>	<ul style="list-style-type: none"> <li>• 3 x STAERALine PBT Sanitary filter housings fully assembled in series mounted on individual tripod stands (free standing)</li> <li>• Optional trolley or stand</li> <li>• Optional diaphragm pressure gauges</li> <li>• Optional diaphragm valves</li> <li>• Optional trolley or stand</li> <li>• Stage 1 filter cartridges</li> <li>• Stage 2 filter cartridges</li> <li>• Stage 3 filter cartridges</li> <li>• Filter cartridge quantity depends on single or multi cartridge configuration</li> </ul>
<b>Number of filtration stages</b>	<p><b>Stage 1</b> Coarse particulate removal</p> <p><b>Stage 2</b> Fine particulate &amp; yeast removal, membrane protection</p> <p><b>Stage 3</b> Sterile filtration and haze reduction</p>	<p><b>Stage 1</b> Coarse particulate removal</p> <p><b>Stage 2</b> Fine particulate &amp; yeast removal, membrane protection</p> <p><b>Stage 3</b> Sterile filtration and haze reduction</p>	<p><b>Stage 1</b> Coarse particulate removal</p> <p><b>Stage 2</b> Fine particulate &amp; yeast removal, membrane protection</p> <p><b>Stage 3</b> Sterile filtration and haze reduction</p>
<b>Filter cartridges in each filtration stage</b>	<p><b>Stage 1</b> CLARISpun – Depth filter cartridge</p> <p><b>Stage 2</b> BREW/Pleat GF - High efficiency pleated filter element (absolute)</p> <p><b>Stage 3</b> STERIPleat W – 0.45 micron absolute rated membrane (optional 0.65 micron)</p>	<p><b>Stage 1</b> CLARISpun – Depth filter cartridge</p> <p><b>Stage 2</b> BREW/Pleat GF - High efficiency pleated filter element (absolute)</p> <p><b>Stage 3</b> STERIPleat W – 0.45 micron absolute rated membrane (optional 0.65 micron)</p>	<p><b>Stage 1</b> CLARISpun – Depth filter cartridge</p> <p><b>Stage 2</b> BREW/Pleat GF - High efficiency pleated filter element (absolute)</p> <p><b>Stage 3</b> STERIPleat W – 0.45 micron absolute rated membrane (optional 0.65 micron)</p>
<b>Connection type &amp; sizes</b>	¾" BSP thread	1" BSP thread. Triclamp or DIN11851 with adaptors from BSP	1", 2", 3" or 4" Triclamp, DIN11851, BSP/NPT threads, flanges
<b>Housing &amp; filter cartridge length</b>	10" or 20" Single cartridge per housing	10", 20" or 30" Single cartridge per housing	10", 20", 30" or 40" Single or multi cartridge configuration

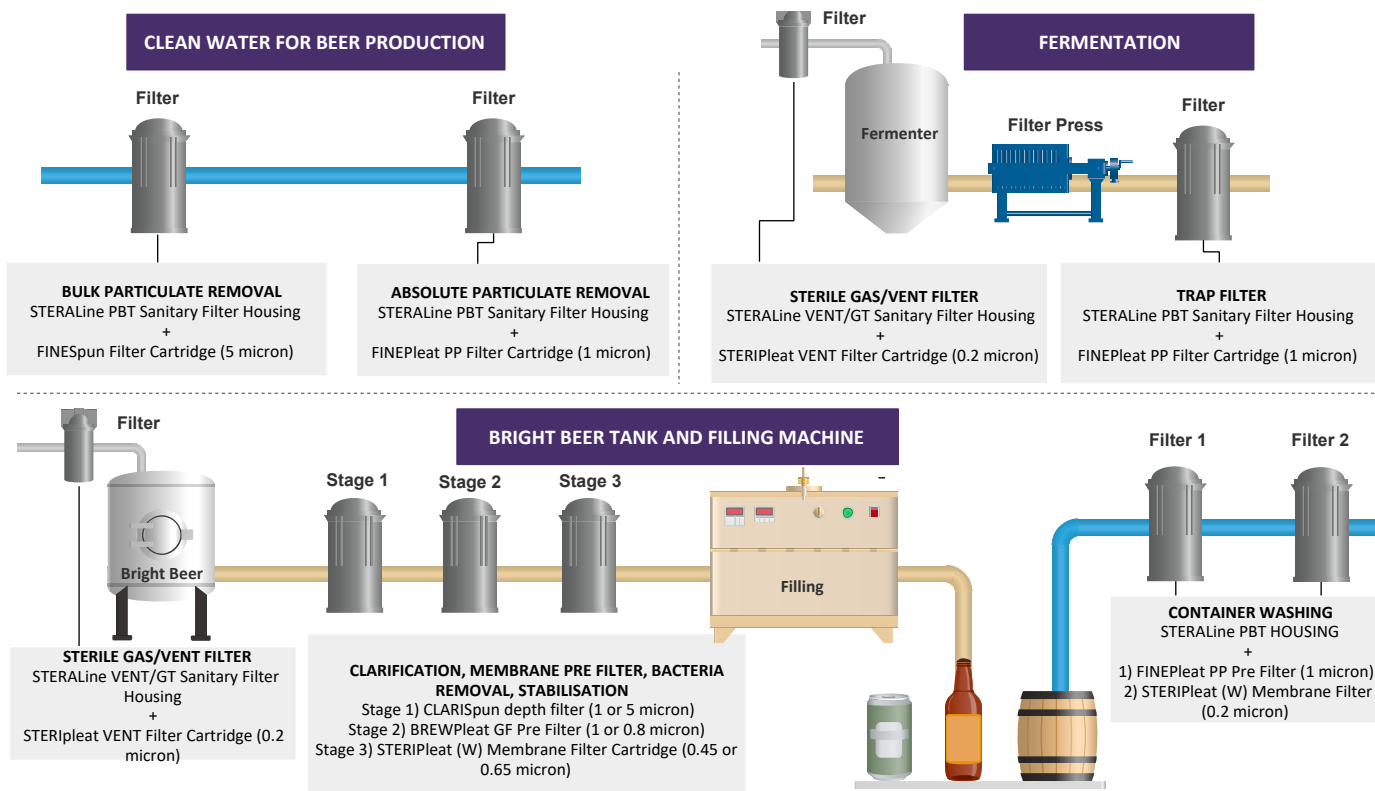

Siga Filtration offers filtration solutions for water, HVAC, metalworking, process, beverage, chemicals, paints & inks industry. Our filters process fluids in installations throughout the world.

All our filter housings comply fully with EU Pressure Equipment Directive (PED). In addition to our standard range, we also design and build filter housings to specifications.

© 2018 Siga Filtration (A Division of Siga UK Limited). All rights reserved.

Siga Filtration Logo is a trademark and service mark of Siga UK Limited. All other marks are properties of their respective owners. The contents of this publication are presented for information purposes only, and while every effort has been made to ensure their accuracy, they are not to be used as warranties or guarantees, expressed or implied, regarding the products and services described herein or their use or applicability. All sales are governed by our terms and conditions a copy of which is available on request. We reserve the right to modify or improve the designs or specifications of our products at any time without notice.

**Siga Filtration**, Unit 27 Craven Court, Glebeland Road, Camberley, Surrey, GU15 3BU, United Kingdom  
 E. [enquiries@sigafiltration.co.uk](mailto:enquiries@sigafiltration.co.uk)  
 W. [www.sigafiltration.co.uk](http://www.sigafiltration.co.uk)  
 T. +44 (0) 1276 583 046